

EXISTING TMO LAYOUT SHEET 7

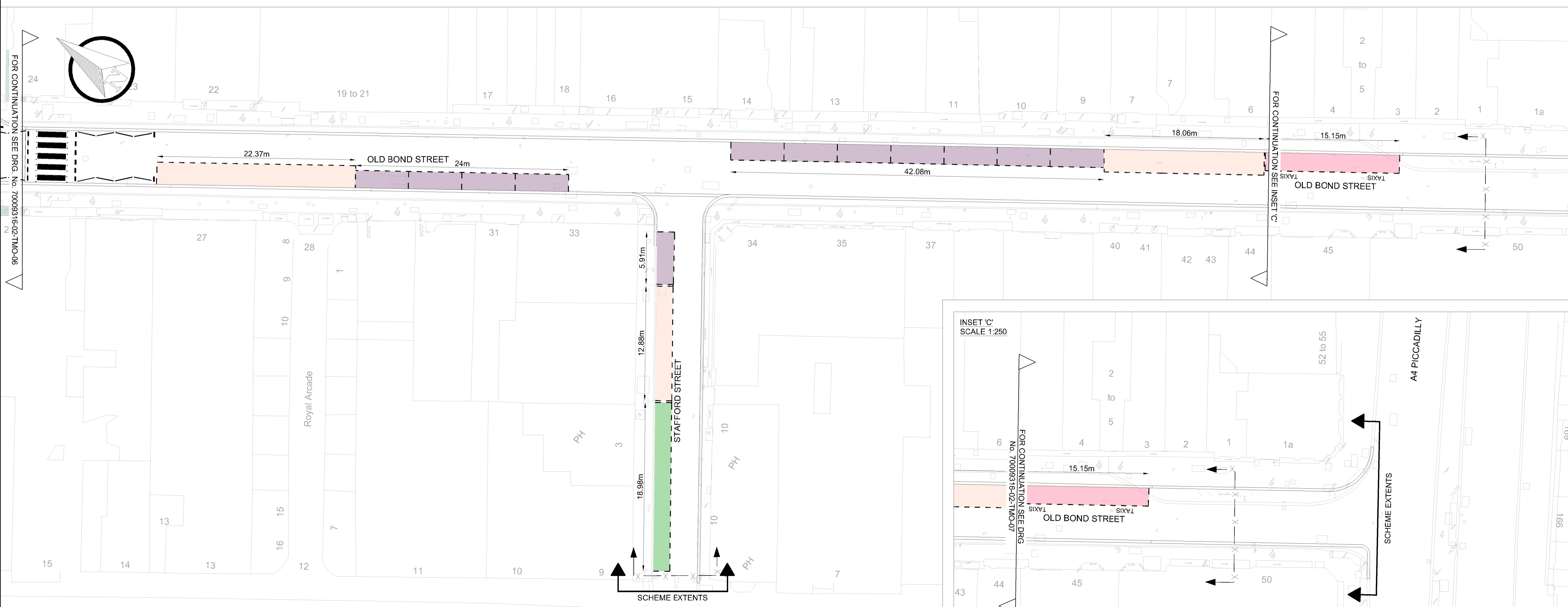

PROPOSED TMO LAYOUT SHEET 7

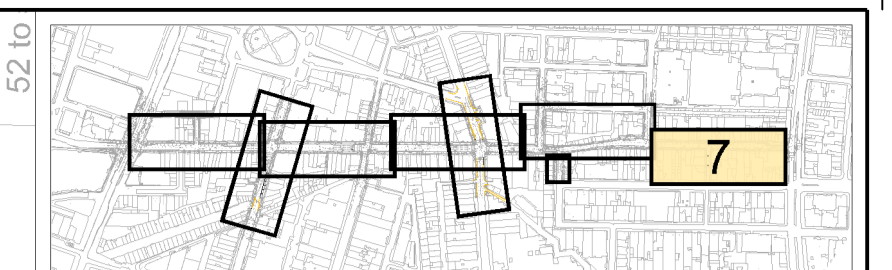

SHEET KEY PLAN

- KEY:**
- 24 HOUR LOADING MAX STAY 20MINS NO RETURN WITHIN 1 HOUR
  - LOADING 08:30 - 18:30 (WAITING PERMITTED 18:30 - 08:30)
  - LOADING 08:30 - 18:30 (PARKING PERMITTED 18:30 - 08:30)
  - LOADING ONLY 16:30 - 16:00
  - LOADING 18:30 - 1:30
  - LOADING 08:30 - 1:30 LOADING PERMIT HOLDERS ONLY, 11:30 - 18:30 (WAITING PERMITTED, 18:30 - 08:30)
  - LOADING, MON-SAT 08:30 - 10:00 LOADING PERMIT HOLDERS ONLY, MON-SAT 10:00 - 18:30 (WAITING PERMITTED, MON-SAT 18:30 - 08:30)
  - RESIDENT PERMIT ONLY EXCEPT SHARED USE PARKING BAY (RESIDENT PERMIT AND PAY-BY-PHONE), MON-SAT 08:30 - 18:30
  - 24 HOUR RESIDENT PERMIT ONLY
  - PAY-BY-PHONE, MON-SAT 08:30 - 18:30 (WAITING PERMITTED, MON-SAT 18:30 - 08:30) UNCONTROLLED SAT 18:30 - MON 08:30
  - 24 HOUR PAY-BY-PHONE
  - 24 HOUR CAR CLUB
  - 24 HOUR TAXIS
  - 24 HOUR DISABLED
  - DISABLED, MON-FRI 08:30 - 18:30
  - 24 HOUR MOTORCYCLES
  - 24 HOUR CYCLE HIRE
  - YELLOW ROAD MARKINGS
  - WHITE ROAD MARKINGS
  - TYPE 1 CYCLE STANDS
  - TYPE 2 CYCLE STANDS
  - RESTRICTED PARKING ZONE
  - RESTRICTED PARKING ZONE EXTENDS BEYOND THIS POINT
  - PROPOSED KERBLINE

B	16.09.2016	MEC	ISSUED FOR CLIENT REVIEW	DA	JN
A	14.09.2016	MEC	ISSUED FOR CLIENT REVIEW	DA	JN
REV	DATE	BY	DESCRIPTION	CHK	APD

DRAWING STATUS: **INITIAL DESIGN**

25 Mandela Way, London, SE1 5SZ  
www.fonway.co.uk www.wspgroup.com

PROJECT: **BOND STREET STREETScape IMPROVEMENTS**

TITLE: **TRAFFIC MANAGEMENT ORDER LAYOUT PLAN SHEET 7 OF 7**

SCALE @ A1	DATE	DESIGN/DRAWN	CHECKED	APPROVED	SHEET
1:250	31-08-2016	SM/MEC	JT	DA	A1
JOB No.	FMC PROJECT No.	BREF/DSS No.			
70009316	TBC	TBC			

DRAWING No.	REV.
70009316-02-TMO-07	B

This map is reproduced from Ordnance Survey material with the permission of Ordnance Survey on behalf of the Controller of Her Majesty's Stationery Office © Crown copyright. Unauthorised reproduction infringes Crown copyright and may lead to prosecution or civil proceedings. (WCC)(LA10009597)